



# 产品说明书

## Product manual

### 产品简介:

MB208是一款高保真小规格点声源音箱，采用全进口单元内置两分频设计。采用两只8寸低音搭配1.4寸驱动器，频率响应可以达到惊人的70Hz-20000Hz(-10dB)，小口径喇叭单元在低失真和人声还原上具有天然优势，饱满厚实的中频，细腻的高频表现，MB208更是将此发挥到极致，对于会议室、报告厅等场所MB208是一款不可多得的佳作。

MB208非常适合在分散式扩声系统中作为区域补声音箱，也可以在小型的环境中单独作为主音箱使用，特别是与MB212SUB超低音箱配合使用时。MB208提供吊装/支架等多种固定安装方式，适用于多种场合的应用安装。



( 示图供参考，可定制其他颜色 )

The MB208 is a high fidelity small-sized point sound source speaker that adopts a fully imported unit with built-in two frequency division design. Using two 8-inch subwoofers paired with a 1.4-inch driver, the frequency response can reach an astonishing 70Hz-2000Hz (-10dB). The small caliber speaker unit has natural advantages in low distortion and vocal reproduction, with a full and thick mid frequency and delicate high-frequency performance. The MB208 takes this to the extreme, making it a rare masterpiece for conference rooms, lecture halls, and other places.

The MB208 is very suitable as a regional supplementary speaker in distributed sound reinforcement systems, and can also be used as a separate main speaker in small environments, especially when used in conjunction with the MB212SUB ultra-low speaker. MB208 provides various fixed installation methods such as lifting/brackets, suitable for installation in various applications.

### Technical Specifications:

箱体: Physical	
木箱材料: Enclosure Material	俄罗斯桦木板
表面喷涂: Finish	黑色聚脲漆(可定制色)
防水等级: Environmental	1px3
连接器: Connectors	2 x Neutrik NL4
安装: Suspension/Mounting	壁挂式/吊装/支撑
产品尺寸: Dimensions	(W)690mm × (H)229mm × (D)236mm/ (W)27.16 × (H)9.01 × (D)9.29in
净重量: Net Weight	18 kg(39.6lbs)

<b>技术指标:</b> Technical data:	
频率响应(+/-3dB): Frequency Response(+/-3dB)	80-19000Hz
频率响应(-10dB): Frequency Range(-10dB)	70-20000Hz
推荐高通滤波器: Recommended High-Pass Protection Filter	70Hz最小12dB/倍频程滤波器
覆盖角度(-6dB): Dispersion	H60° × V80°
连续功率: Nominal Power Handling	560W (AES)
峰值功率: Power Handling, Peak	2240W
灵敏度: Sensitivity(SPL/1W@1m)(2)	100dB
最大声压级: Calculated Maximum SPL@1m, peak	133.5dB
<b>扬声器:</b> Transducers	
低音扬声器: Low Frequency	2 × 8"18Sound低音扬声器(2"voice coil )
高音驱动器: High Frequency	1 × B&C 高音钹磁驱动器 ( 1.7"voice coil )
额定阻抗: Nominal Impedance	8 Ohms

## Dimensions

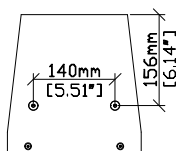

top(俯视图)

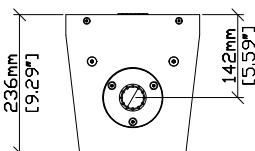

bottom(仰视图)

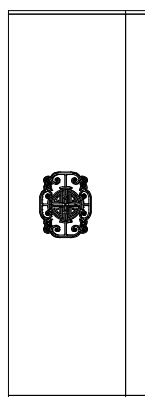

side(侧视图)

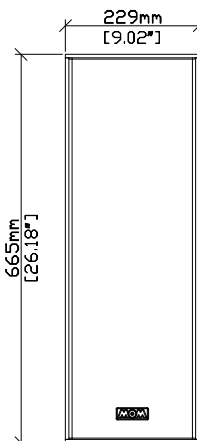

front(前视图)

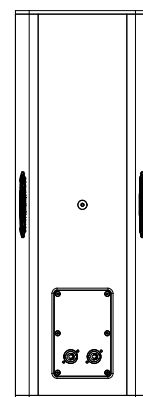

back(后视图)

### Frequency Response

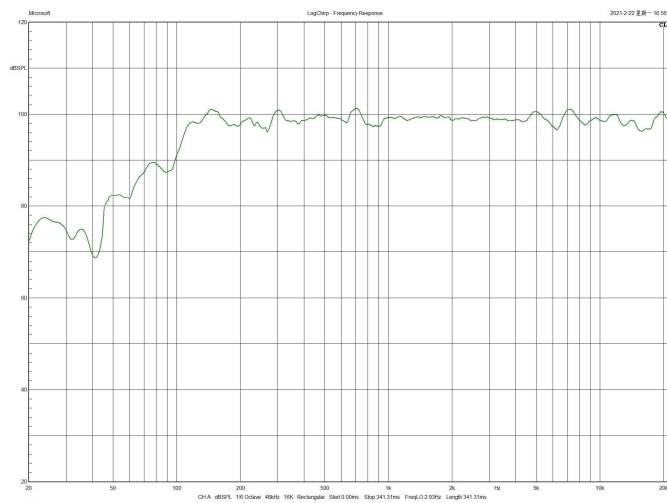

### Distortion

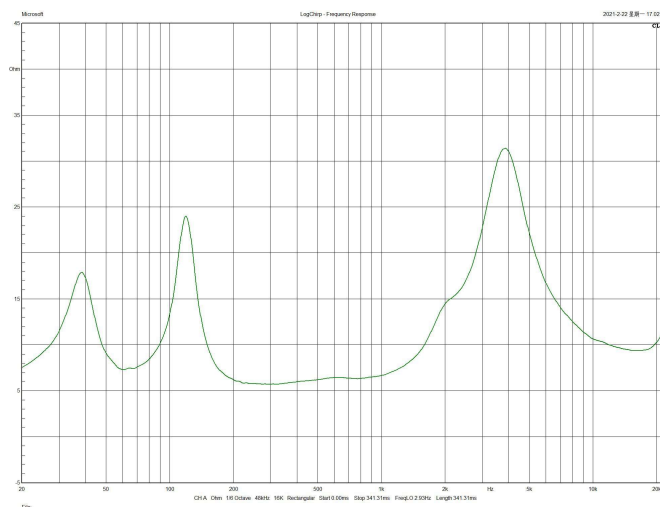

注悉：

1.以上频响曲线及参数均在消声环境中测得.

2.相关测试执行以下标准：

GB/T9397-2013《直接辐射式电动扬声器通用规范》.

GB/T12060.5-2011《声系统设备 第5部分：扬声器主要性能测试方法》.

3.额定功率按照AES标准2小时连续时间.

4.本公司保留最终解释权.